

TORLYS and Quick•Step® Surface Waterproof Laminate

DEAR CUSTOMER,

You have purchased a quality TORLYS / Quick•Step® Surface Waterproof laminate floor, well suited for all residential rooms, including bathrooms*. Please take a moment to review the installation instructions and plan your installation carefully.

Please note that IMPROPER INSTALLATION CAN VOID WARRANTIES. Installation of 100 square feet (9m²) of flooring is enough to verify quality and acceptance.

**TORLYS Laminate flooring is not suitable for use in SAUNAS or other abnormal use or conditions including, but not limited to, water damage from plumbing, storms, floods, and water saturation on the surface or trapped between subfloor and floor.*

IMPORTANT: Before starting the installation, please carefully read this entire document, paying special attention to (section 6) Completing the Installation.

SET UP

To ensure you have sufficient material on hand, calculate the total area of the room and add 5% of material to allow for custom cutting.

For acclimation, 48 hours prior to installation, place the closed packages in the middle of the properly conditioned room (see LAYOUT section), NEVER against a wall or in a corner. Do not open the packages until you are ready to begin installation. Inspect each plank before installation. If you find any defects, either cut out the defect or do not use the plank. Contact your dealer immediately.

PLEASE NOTE: The TORLYS Warranty does not cover labour for installation of planks with visible defects.

PREPARATION

Remove existing carpet, baseboards, quarter-boards, and thresholds. Undercut door jambs using a piece of flooring material (plus the respective underlay) as a guide. Repair all defects in the subfloor. Additional expansion and contraction space can be achieved by undercutting drywall.

CHECK THAT:

- The jobsite has been cleaned and cleared of debris that could potentially damage the finish of your TORLYS floor.
- The doors can still open and close after installing the floor.

- Doors may have to be cut to supply sufficient clearance.
- The door jambs may need to be adapted to install the floor under them.
- For aesthetic appearance we suggest that you measure the width of the room to ensure that the width of the pieces of the first and last row is approximately the same and not less than 3" (7.5 cm). Cut the width of the pieces of the first and last row as needed.

SUBFLOORS

Repair any defects in the subfloor. Installation over an uneven subfloor will cause premature damage to floor and make the floor feel unstable. All subfloors must be clean, firm, flat (within 3/16" - 4.8 mm in 10 ft - 3 m), smooth and dry.

The moisture on concrete slabs must be equal or less than 80% Relative Humidity (RH) with an *in-situ* probe as per ASTM F2170, 12% or less on plywood). You can lay the planks over any solid and stable subfloor material, including plywood, chipboard, old non-creaking flooring boards, hardwood flooring, concrete slabs, PVC, or most ceramic tile (avoid heavily embossed tile).

DO NOT install over existing carpet. Wood subfloors must be structurally sound. Any loose parts must be nailed or screwed and, if necessary, a levelling compound must be applied. It is essential that the crawl space under subfloors is sufficiently ventilated. Remove any obstacles and provide sufficient ventilation. A 6 mil (0.15 mm) poly vapour barrier must be installed on the crawl space floor*.

** In construction terminology, a crawl space is defined as: "a shallow space below the living quarters of a house, normally enclosed by the foundation wall..."*

LAYOUT

The floor should be installed from several cartons at the same time to ensure colour and shade mix. If possible, lay the planks parallel to window light.

The ideal environment is a temperature of 60 °F - 70 °F (16 °C - 21 °C) and relative humidity of 40 - 60%.

The floor will be stronger and more stable if the joints are staggered at least 12" (30 cm) in each row. Staggered or irregular joints result in less waste and enhance the overall appearance of the floor. Do not stair step the flooring across the room. All mouldings, door frames, etc., should be

undercut to allow an expansion and contraction space around the entire perimeter of the floor. Be sure to leave the minimum 1/2" (13 mm) expansion and contraction space on all sides of the floor, around pipes, thresholds, under doors and around any fixed objects (floor vents, kitchen cabinets/islands, etc.).

Kitchen cabinets/islands should not sit on the flooring as this will prevent natural expansion and contraction due to climate fluctuations.

Any wedges should be removed after the flooring installation has been completed, and the expansion/contraction space should be covered by baseboard, quarter round/shoe mould, and/or drywall (if wall is undercut).

NOTE:

Never hit the planks directly with your hammer or rubber mallet. When required, use a TORLYS Tapping Block or TORLYS Bulldog™ Tool** to protect the edges of the planks. Make sure the Tapping Block is in good condition. Hold Tapping Block down when using it. Gently tap all planks into their final locking position.

TOOLS

- Hammer (1 lb.)
- Tape Measure
- Pencil
- Saw
- Last-board Puller*
- TORLYS Tapping Block*
- 3/8" (8 - 10 mm) wedges*
- Mask (3M™ Tekk Protection™ Sanding and Fibreglass Disposable Respirator, 8200HB5-A), or equivalent



When sawing pieces off the planks, use a fine-toothed hand saw, jigsaw, chop-saw, or guillotine.

*Note: available in a TORLYS Installation Kit.

**OPTIONAL: for installation and repairs use TORLYS Bulldog™ tool.

FLOATING METHOD

Prepare the subfloor. The recommended underlays are: TORLYS XV, TORLYS 3-in-1, TORLYS Acoustik, TORLYS Safe and Sound, or TORLYS CorkPlus BLUE. Cover all subfloor with TORLYS underlayment, rolled out and taped at seams. The TORLYS XV/ 3-in-1/ Acoustik/ Safe and Sound underlayments include a 3" adhesive overlap, which makes the use of damp-proof tape necessary only at the short ends of the rolls. When using TORLYS cork underlayment over cementitious subfloors, first cover the subfloor with 6 mil (0.15 mm) poly, overlap

edges by 12" (30 cm), damp-proof tape the seams and run up 4" (10 cm) on each wall. Products with an attached underlayment will also require a separate 6 mil (0.15mm) poly vapour barrier.

Do not glue planks together.

PREVENTATIVE MAINTENANCE

To ensure the full benefit of the TORLYS Laminate Waterproof Flooring warranty and to extend the beauty of your new floor for years to come, we recommend the following preventative maintenance suggestions:

- Install floor protectors on furniture legs to protect against scratches and dents. These furniture pads should have no wrinkles and be made of soft, non-staining material (e.g., felt pads); the felt pads should be of adequate size to support the weight of the furniture and a minimum of 1" (2.5 cm) in diameter. The floor protectors should sit flat on the floor and be inspected periodically for cleanliness and wear. For heavy pieces of furniture (e.g., couches) the use of coaster-cups is recommended.
- Do not drag furniture or other heavy objects on the floor. Avoid high heels or shoes that need repair. Some types of high heels can severely damage the surface of any floor covering. For damages that require plank replacement, the TORLYS Bulldog™ tool is available through your dealer.
- Sweep and vacuum floor regularly. Use correct hard surface vacuum tools. DO NOT use rotating beater bars, floor scrubbers, jet mops, buffers, or similar products.
- Avoid sand and grit build up.

At doorways and areas of heavy wear, use protective mats or rugs that are marked "non-staining".

For dry maintenance, use a dust mop, vacuum cleaner, or dry cloth. For damp maintenance, use the TORLYS EcoCare Cleaning Kit, available from your Authorized Dealer, and following the maintenance instructions on the container.

Basic cleaning is with a damp cloth.

Surface Waterproof products may be maintained with a residential steam mop on the lowest temperature setting.

IMPORTANT! To keep your warranty valid, use TORLYS recommended maintenance products and follow TORLYS maintenance instructions. For more information on Maintenance products and instructions go to: www.torlys.com.

Maintain the humidity level at 30 - 60%. Certain regions have extreme changes in humidity levels, which may affect all floors. To maintain humidity within a healthy range, a humidifier or

dehumidifier may be required. Never oversaturate your TORLYS Laminate floor. Never wax or use oil-based products on your TORLYS Laminate floor.

INSTRUCTIONS

1) GENERAL

IMPORTANT!

Use a hammer and the special TORLYS tapping block. Never use any other tapping block, as it may damage the planks.

Use a TORLYS “last-board puller” to pull exposed joints tight, where a tapping block and hammer will not fit. For a short edge, use several small taps until the planks click together completely.

For a long edge, tap planks together gradually. Begin tapping lightly at the corner of a plank until the joint has clicked together.

Repeat the process approximately every 12” (30 cm) until the entire long edge of the plank has clicked in with the next plank.

Never attempt to knock the joint into place with just one hit.

For the best results, follow the installation instructions and use only:

- A) TORLYS INSTALLATION KIT (Spacer wedges, tapping block and last-board puller).
- B) TORLYS MAINTENANCE KIT. (TORLYS EcoCare (pH Neutral) Cleaner).
- C) TORLYS BULLDOG™ TOOL.
- D) 6 MIL POLY VAPOUR BARRIER for installations of cork underlayment or products with an attached underlayment over cementitious subfloors.

2) CORRECT INSTALLATION

Wood is the primary component of TORLYS Laminate flooring. Since the humidity of a room can vary from one season to the next, the floor must be able to expand and contract in ALL directions. A minimum of 1/2” (13 mm) expansion and contraction space must be provided at all walls, around pipes and at thresholds. These spaces should be covered by a moulding that is not fixed to the floor but to the subfloor (T-moulds, Reducers, Square-nosing) or to the wall (baseboard, quarter-round or additional shoe

moulding). Provide expansion and contraction space under doors frames. Install the planks in the same direction as the longest wall, or if possible, parallel to window light for a more appealing look.

Begin installing the floor from the left corner of the room. Always remember that the easiest way to install the floor is by placing the tongue (A) into the groove (B).

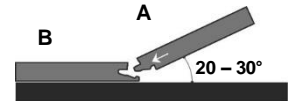

Tapping block position for 8 mm floors.

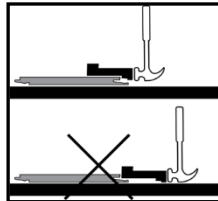

Tapping block position for 12 mm floors.

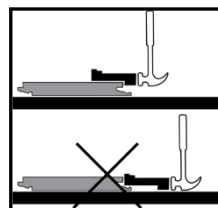

TRANSITION MOULDINGS

Installation cannot exceed 50’ (15 m) in any direction without installing a transition moulding (e.g., T-Moulding).

Transitions are required in doorways less than 30”

MATCH TRANSITION MOULDINGS (E.G. STAIR NOSINGS)

For the best appearance compare the transition mouldings and flooring before installation, identify the planks that best match the mouldings for colour and grain, set them aside and then install them as needed. Note: If using flush-mount stair nosing in conjunction with this flooring, do not commence installation before referring to stair nosing instructions.

3) THE FIRST ROWS

Saw off the tongue of the first plank, both on the short as well as the long edge. For all other first row planks cut off the tongue on the long edge (Photo I).

Orient the first plank in the left corner of the room. Maintain a minimum spacing of 1/2” (13 mm), using wedges. Lay the planks with the groove side facing you (I) to use the tongue/groove system. Lay the first rows along the wall.

Note that an expansion and contraction space of 1/2” (13 mm) must be provided at the wall, as well as at all columns, pipes, door frames, etc.

Turn plank inclined with the end joint into the already laid plank. Click the two together. Ensure that the planks of the first row are straight (II).

The cut piece from the first row becomes the starting piece for a subsequent row. The cut pieces should be a minimum of 12” (30 cm) in length (III). Install the cut edge facing the wall, with the expansion wedge in place.

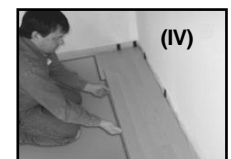

Now angle this piece and click it into the first plank of the first row. Continue the second row with a full piece, placing the tongue of the long side into the groove of first row piece (IV).

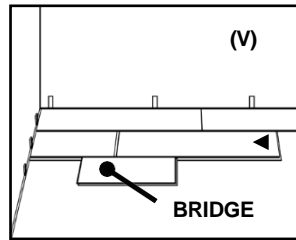

Move the end joints together until they are approximately 1/4" (6 mm) apart. Click the plank lengthwise into place. For the short edge, use several smaller taps with the TORLYS tapping block until the planks click into place completely.

For longer length products, use a scrap piece of floor as a bridge, to assist lining up the short sides to tap on the opposite end (V).

Do not attempt to knock the joint into place with one hit.

Continue this method for each plank, covering the entire width of the room.

PLEASE NOTE that the stagger between the head joints should be 12" (30 cm). Cut the last planks of each row leaving a 1/2" (13 mm) space to the wall.

4) THE FINAL ROW

There should be a 1/2" (13 mm) expansion and contraction space between the final row and the wall. To create this, saw off the long edges of the last row of planks. Place the planks one by one next to the planks of the previous row. Tap the edges together using the last board puller and hammer. Tap the short edges together using the tapping block.

5) UNDER DOOR FRAMES

Saw the planks so that after installation there is a 1/2" (13 mm) expansion and contraction space. This expansion/contraction space can be covered by undercutting the door jamb. If you cannot incline and click this plank, use the last board puller, the TORLYS tapping block, or TORLYS Bulldog™, and hammer to tap the planks together.

6) COMPLETING THE INSTALLATION – WATERPROOF*

After installing your floor, you can immediately walk on it and begin the final touches. This is one of the major benefits of the glue-less system.

Remove any spacer wedges and, to create a waterproof seal around the entire perimeter, first fill all expansion spaces with compressible 1/2" (12 mm) PE foam backer rod (type Climashield or Climaloc); next, create a watertight seal by

applying waterproof, flexible, 100% silicone sealant on top of the foam backer rod, covering at least 1/8" (3 mm) of the floor and 1" (2.5 cm) running up the wall (which will then be covered by baseboard, and quarter-round/shoe mould, if required) or the door stop.

Prior to installing the mouldings, first fasten the track to the subfloor, then apply the flexible silicone sealant along the portion of the moulding that will contact directly with the laminate flooring surface. Install mouldings and immediately wipe away any excess silicone sealant.

Apply flexible silicone sealant to door frames and trims or any other fixed objects.

Please see drawings below.

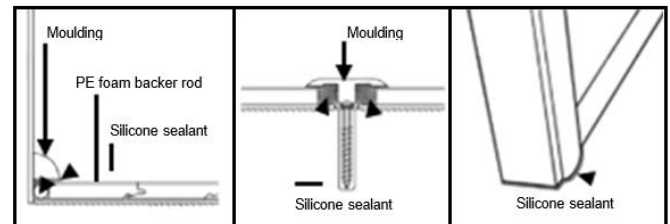

*For non-waterproof installations, PE foam backer rod and silicone sealant are not required.

IN BATHROOMS: the use of a flexible silicone to seal the expansion and contraction space is mandatory in all bathroom installations.

7) RADIANT HEAT APPLICATIONS

TORLYS and Quick•Step® Laminate floors are guaranteed for installation over radiant-heated subfloors. For details and limitations, please check the "TORLYS Flooring Warranty and Instructions for installation over radiant-heated subfloors".

Visit our website at: www.torlys.com, for detailed information.

ATTN: INSTALLERS CAUTION: WOOD DUST

Sawing, sanding, and machining wood products can produce wood dust. Airborne wood dust can cause respiratory, skin and eye irritation. The International Agency for Research on Cancer (IARC) has classified wood dust as a nasal carcinogen in humans.

PROPOSITION 65 WARNING: Produces wood dust when cut. Wood dust is known to California to cause cancer.

PRECAUTIONARY MEASURES: Power tools should be equipped with a dust collector. If high dust levels are encountered use an appropriate NIOSH designated dust mask. Avoid dust contact with skin and eyes. First Aid Measures in case of irritations: In case of irritation flush eyes and skin with water for at least 15 minutes.

For questions, please contact TORLYS Customer Service at 1-800-461-2573 and ask for the Technical Department.

WARNING! Do not mechanically chip or pulverize existing resilient flooring, backing, lining felt, asphaltic "cutback" adhesives or other adhesives. Previously installed resilient flooring may contain either asbestos fibers or crystalline silica. The products in this box do not contain asbestos.

Avoid creating dust. Inhalation of such dust is a cancer and respiratory tract hazard. Smoking by individuals exposed to asbestos fibers greatly increases the risk of serious bodily harm. Unless positively certain that the product is a non-asbestos containing material, you must presume it contains asbestos.

Regulations may require that the material be tested to determine asbestos content and may govern the removal and disposal of material. See current edition of the Resilient Floor Covering Institute (RFCI) publication "*Recommended Work Practices for Removal of Resilient Floor Coverings*" for detailed information and instructions on removing all resilient covering structures.

Head Office: TORLYS Inc.
1900 Derry Road E., Mississauga, Ontario L5S 1Y6 Canada
www.torlys.com